

# **Appendix B. Landscape General Arrangement Plan**



- NOTES:**
1. THE GENERAL NOTES, ABBREVIATIONS AND COMMON LEGENDS REFER TO DRAWING NO. ACM/P282RD-RDL/JDR/8000501 UNLESS OTHERWISE STATED.
  2. THIS DRAWING IS READ IN CONJUNCTION WITH DRAWING NOS. ACM/P282RD-RDL/JDR/8000502 TO 8000504, UNLESS OTHERWISE STATED.
  3. THE CONTRACTOR SHALL BE RESPONSIBLE TO OBTAIN NO OBJECTION FROM PROJECT MANAGER AND THE MAINTENANCE PARTY FOR ANY REINSTATEMENT WORKS REQUIRED PRIOR TO THE COMMENCEMENT OF WORKS.
  4. INFORMATION FOR ALL EXISTING PLANTING AND PLANTING TO BE DONE BY OTHER GOVERNMENT CONTRACTS ARE FOR REFERENCE. ONLY THE CONTRACTOR SHALL BE RESPONSIBLE TO VERIFY ON SITE AND LIAISE WITH THE RELEVANT GOVERNMENT DEPARTMENTS FOR THE LATEST INFORMATION.

- LEGEND:**
- SITE BOUNDARY
  - PROPOSED PLANTING AREA
  - EXISTING PLANTING AREA WITH SPECIES CODE FOR REFERENCE (REINSTATEMENT FOR THE PLANTING AREA AFFECTED BY THE WORKS IS REQUIRED AND SHALL REFER TO NOTE 4)
  - PLANTING AREA BY OTHER GOVERNMENT CONTRACT (REINSTATEMENT FOR THE PLANTING AREA AFFECTED BY THE WORKS IS REQUIRED AND SHALL REFER TO NOTE 4)
  - EXISTING TREES TO BE RETAINED

PLANTING SCHEDULE FOR REINSTATEMENT WORKS AND READ IN CONJUNCTION WITH DRAWING NOS. ACM/P282RD-RDL/JDR/8000502 TO 8000504 (SEE NOTE 4).

SHRUB PLANTING				
SPECIES CODE	BOTANICAL NAME	CHINESE NAME	SIZE (HEIGHT H x SPREAD SP) mm	SPACING mm
Mar	Mavaviscus arboreus	大紅袍	700 H X 500 SP	450
Ste	Strelitzia reginae	天堂鳥蕉	500 H X 400 SP	350
Fmi	Ficus microcarpa "Golden leaves"	黃金榕	1000 H X 700 SP	600
Pmy	Phyllanthus myrsinifolius	瘤藤葉下珠	400H X 300 SP	250
Aod	Aglaa odorata	米仔蘭	700 H X 500 SP	400
Mli	Michelia figo	含笑	800 H X 500 SP	400
Rpu	Rhododendron pulchrum	錦繡杜鵑	600 H X 400 SP	300

GROUND COVER PLANTING				
SPECIES CODE	BOTANICAL NAME	CHINESE NAME	SIZE (HEIGHT H x SPREAD SP) mm	SPACING mm
Oja	Ophiopogon japonicus	麥冬	150 H X 150 SP	100
Wtr	Wedelia trilobata	蜂頭菊	100 H X 100 SP	100
Lsp	Liriope spicata	山琴冬	100 H X 100 SP	100
Zan	Zephyranthes candida	惠蓮	100 H X 100 SP	100
Zo	Zephyranthes rosea	玫瑰蔥蓮	150 H X 200 SP	100
Lmo	Lantana montevidensis	縷地黃金蕒	200 H X 300 SP	200
Spo	Syngonium podophyllum	合果芋	200 H X 300 SP	200
Nax	Nephrolepis exaltata	毛蕨	150 H X 200 SP	150

LAWN/ GRASS				
SPECIES CODE	BOTANICAL NAME	CHINESE NAME	SIZE (HEIGHT H x SPREAD SP) mm	SPACING mm
Za	Zoysia sp.	刺刺草	25 H	/

TREE				
SPECIES CODE	BOTANICAL NAME	CHINESE NAME	SIZE (HEIGHT H x SPREAD SP) mm	SPACING mm
BV	Bauhinia variegata	豔粉草錦甲	4000-5000(H) x 3000(SP) x 100(DH)	4000
GB	Grevillea banksii	紅花銀柳	3000-4000(H) x 2500(SP) x 100(DH)	3000
JCX	Juniperus chinensis 'Kialzuka'	藍柏	4000-5000(H) x 3000(SP) x 100(DH)	4000

MATCH LINE - FOR CONTINUATION SEE DRAWING NO. ACM/P282RD-RDL/JDR/8000503

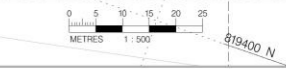

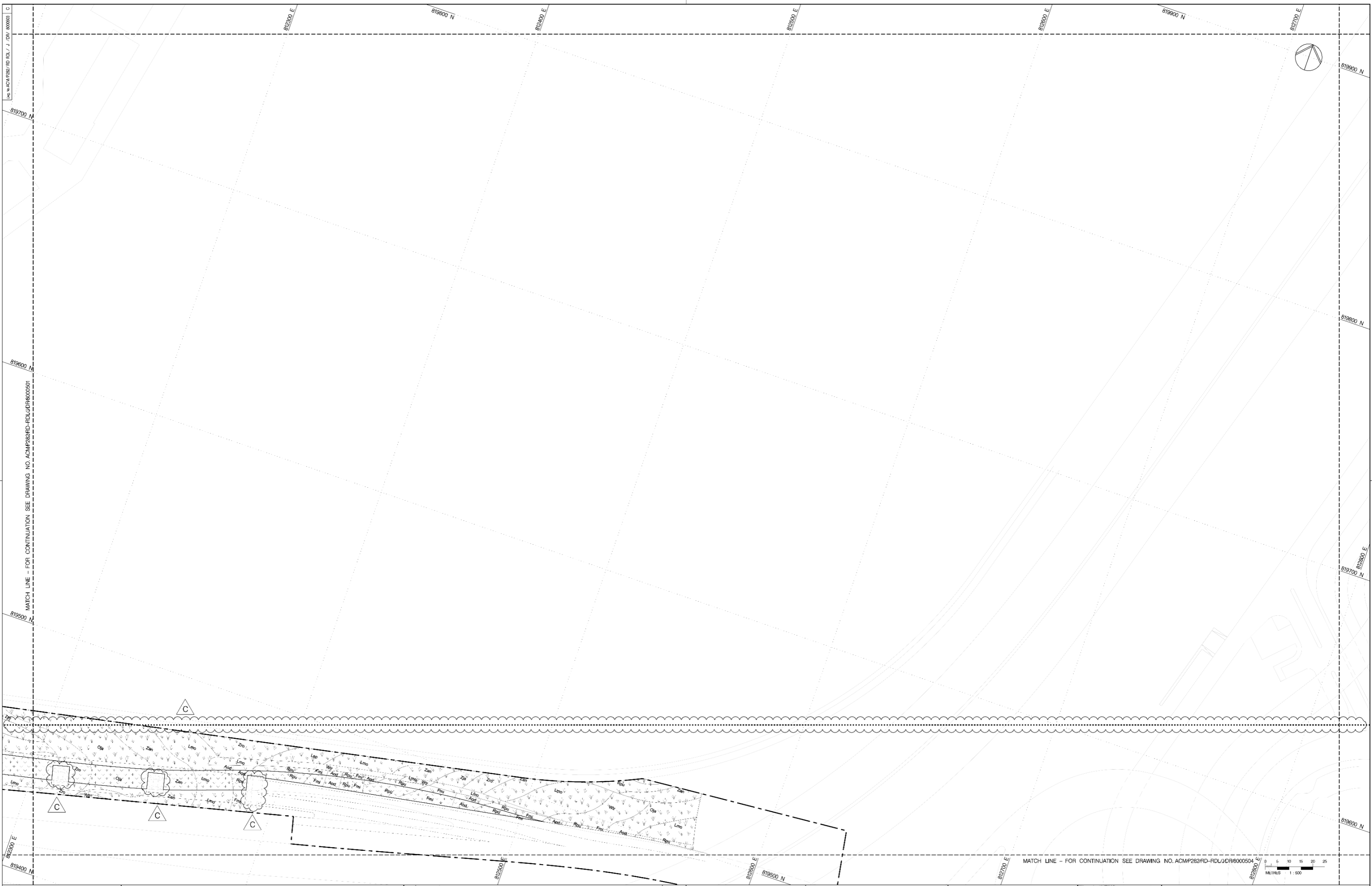

US 304/PS2/BD-RDL/J.DR/ 800650 C

MATCH LINE - FOR CONTINUATION SEE DRAWING NO. ACOMP282RD-RDL/DR8006501

MATCH LINE - FOR CONTINUATION SEE DRAWING NO. ACOMP282RD-RDL/DR6000504

